

distinctive advantages

- Energy Saving
- High Efficiency
- Fast Response Time
- Low Sound Level
- Fail-Safe
- Easy Installation
- Compact Dimensions
- Low Weight

Specification

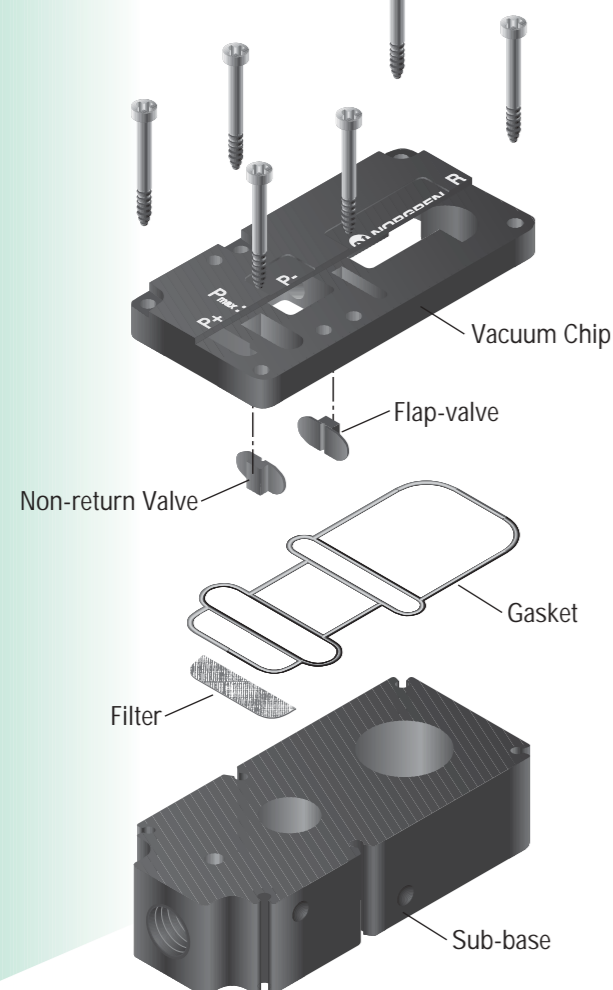

IMI Norgren GmbH, Actuator Division
 Bruckstraße 93, D-46519 Alpen, Germany
 ☎ +49-2802/49-0, Fax +49-2802/68 04



3/1998 ACP 510



Norgren is a leading world manufacturer and supplier of pneumatic solutions, offering a comprehensive range of pneumatic control and automation components via a global sales and service network which covers 70 countries worldwide. The company is a principal member of the diverse and internationally successful £1 billion IMI Group.



Vacuum Program

Series M/58000

Pumps, Suction Cups, Accessories



The Norgren Vacuum Pumps

The Principle

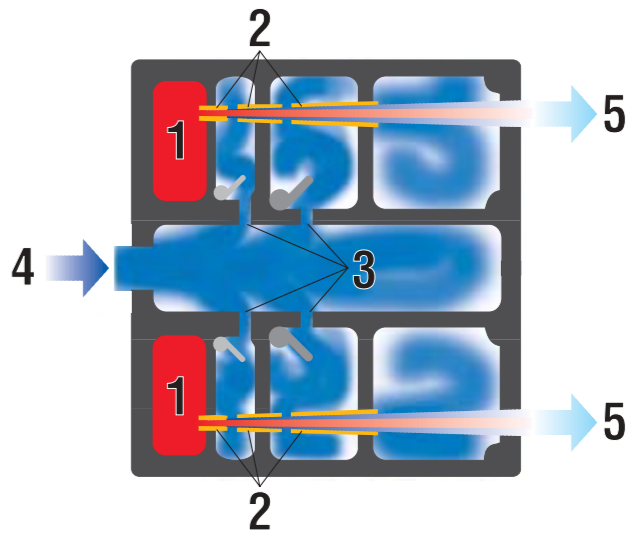

Norgren vacuum pumps are operated according to the principle of ejector pumps driven by compressed air. The compressed air flows through the chamber (1) into the ejector, where it expands in the ejector nozzles (2). The speed of the compressed air jet increases rapidly, while pressure and temperature decrease, attracting more air from the chamber (3). This creates a vacuum at the vacuum port (4). The air exhausts at the port (5).

Superb Modular System

87% Vacuum

Induced Air 80 to 910 NI/min



The Vacuum Program with many accessories available

Suction Cups

Flat Suction Cups M/58300/01

Diameter: 6 to 150 mm
Operating Temperature: -10 to 70°C
Material: Nitrile



Flat Suction Cups M/58300/02

Diameter: 6 to 150 mm
Operating Temperature: -30 to 200°C
Material: Silicone



Bellows Suction Cups M/58400/01

Diameter: 10 to 150 mm
Operating Temperature: -10 to 70°C
Material: Nitrile



Bellows Suction Cups M/58400/02

Diameter: 10 to 150 mm
Operating Temperature: -30 to 200°C
Material: Silicone



Accessories for Flat Suction Cups and Bellows Suction Cups

Level Compensators M/58007, M/58008, M/58009



Ball Joint Connectors M/58001, M/58002



Vacuum Pumps

M/58102/10 M/58102/N/10 (with integrated non-return valve)

Induced Air: 80 NI/min*
Air Consumption: 50 NI/min*
Weight: 0,08 kg



M/58102/20 M/58102/N/20 (with integrated non-return valve)

Induced Air: 160 NI/min*
Air Consumption: 100 NI/min*
Weight: 0,095 kg



M/58102/30 M/58102/N/30 (with integrated non-return valve)

Induced Air: 240 NI/min*
Air Consumption: 140 NI/min*
Weight: 0,11 kg



M/58102/60 M/58102/N/60 (with integrated non-return valve)

Induced Air: 480 NI/min*
Air Consumption: 280 NI/min*
Weight: 0,855 kg



M/58102/90 M/58102/N/90 (with integrated non-return valve)

Induced Air: 708 NI/min*
Air Consumption: 420 NI/min*
Weight: 1,105 kg



M/58102/120 M/58102/N/120 (with integrated non-return valve)

Induced Air: 910 NI/min*
Air Consumption: 530 NI/min*
Weight: 1,15 kg



Accessories

Switches, Vacuum Gauge, Silencer

Pneumatic Vacuum Switches
M/58021 normally open
M/58022 normally closed
Operating Temperature: 60°C max.



Electric Vacuum Switches
M/58024/VB normally open
M/58024/VF normally closed
Operating Temperature: 80°C max.



Electronic Vacuum Switches
M/58027/VAN/P (NPN)
M/58027/VAP/P (PNP)
Operating Temperature: 50°C max.



Vacuum Gauge M/58080
Display 0 to -1 bar
Operating Temperature: 60°C max.



Silencer M/58019
Operating Temperature: 80°C max.



Specifications

Vacuum pumps



Medium: Compressed Air, filtered and non-lubricated



Operating Pressure: 6 bar max.



Sound Level: 75 to 80 dB(A)

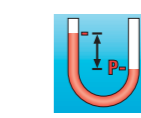

Vacuum max.: -0,87 bar (87%)



Operating Temperature: 80°C max.: M/58102/10 to M/58102/30
60°C max.: M/58102/60 to M/58102/120
(without vacuum gauge 80°C max.)

*Induced air and air consumption are measured at 6 bar